



UNI-COM

Rechargeable COB LED flood light

Model: 63957

Operating instructions

Assembly

- (1) Loosen the knobs either side of the head unit and fold down the bracket. Tighten knobs to secure in position.
- (2) Remove the fixing bolt from the base.
- (3) Attach the head unit to the base by passing the bolt through the centre hole in the bracket and screwing it into the base.

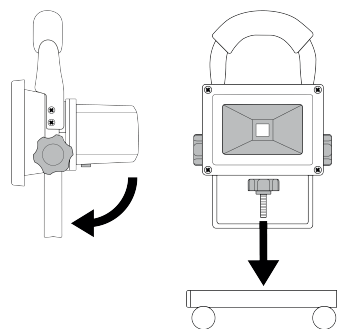

Important before use

- (1) Fully charge the flood light using the mains adaptor (instructions overleaf)

Directions for use

- (1) Press the switch under the head unit to turn the light on and off.
- (2) The angle of the light can be adjusted by loosening the knobs either side of the head unit and tilting to your chosen angle. Tighten the knobs to secure in position.

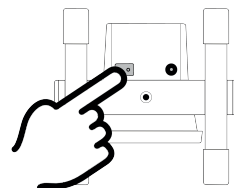

Please turn over



Charging the battery

- (1) Ensure the flood light is turned off.
- (2) Insert the required adaptor lead into the DC socket under the head unit. Plug the other end into either the mains socket and switch on, or your car cigarette lighter socket while the car is running.
- (3) A red LED will light on the front of the adaptors to show the battery is charging, it will turn green when the battery is fully charged.
- (4) A full charge will take approximately 4 hours.

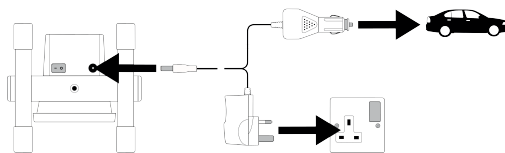

Important - charging the battery with the car adaptor should always be done whilst the vehicle engine is running to avoid discharging the vehicle battery.

N.B. The flood light can be powered directly from the mains using the mains adaptor.

Maintaining the quality of the rechargeable battery



DO NOT leave the battery fully discharged.

If the flood light is not going to be used for a period of time, fully charge the battery using the adaptors before storage. The battery should then be fully charged **every 4 months** to keep the battery in good condition and the flood light ready to use.

Safety warning

Keep out of reach of children. Do not shine light directly into eyes. Only use the adaptors supplied. Do not leave unattended while charging. Disconnect when fully charged.

Batteries



This product is fitted with 7.4V 4400mAh Li-ion battery. It should be removed prior to disposal. To access the battery remove the four screws on the back of the head unit. Help the environment by disposing of your product and batteries responsibly.

Guarantee

This product is guaranteed for one year from the date of purchase against faulty parts or workmanship. It does not cover physical damage to the unit. Proof of purchase required. This does not affect your statutory rights.



Made in China

Uni-Com (Global) Ltd.
1 & 2 Enterprise Way,
Edenbridge, Kent, TN8 6EW

+44 (0)1732 865238
info@uni-com.co.uk
www.uni-com.co.uk